



Designer Finished Home

THE RIDEAU

bungalow + loft

Lot #7 1980 sq ft



Designer Finished Home

THE RIDEAU

bungalow

Lot #7 1980 sq ft

Enjoy a simplified and refined main level living space with a private loft retreat. Professionally selected, the finishes and complimentary colours of this Land Ark home express the comfort of simplicity. Additional space in the loft, blends harmoniously to create a well appointed, lasting style that will be pleasing for many years to come.



WATERCOLOUR
WESTPORT

New Homes New Life New Possibilities



Designer Finished Home

THE RIDEAU

bungalow + loft

Lot #7 1980 sq ft



WATERCOLOUR

WESTPORT

MAIN FLOOR - 1200 sq ft

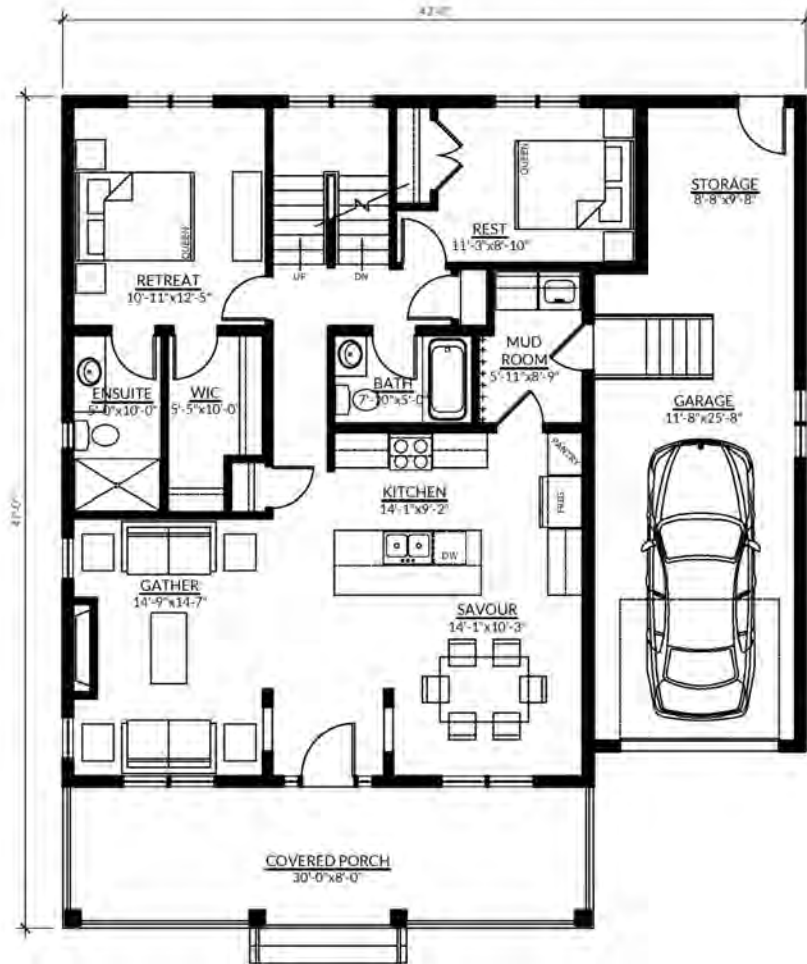

LOFT - 780 sq ft

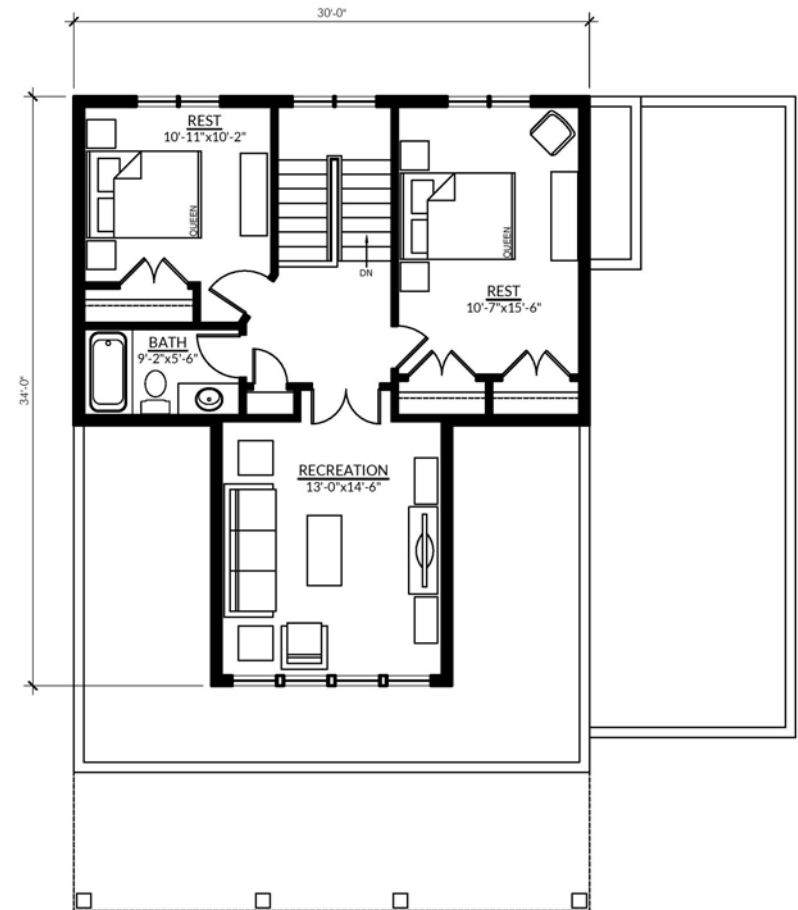

All images on all pages are artist's concept and may vary slightly from the final product. Actual usable floorspace may vary from stated area and square footage has been calculated based on usable living space according to the TARIION rules and does not include garage or unfinished basement areas. Images may show optional features which may not be included in the base price. Bulkheads & box outs may be required as chases for plumbing & mechanical. Garage main door location, if applicable, may vary subject to grade. Specifications subject to change without notice. Manufacturer's images are shown and may differ from the final product. E. & O.E. May 2021.

WESTPORT VILLAGE ACTIVITIES FOR THE WHOLE FAMILY

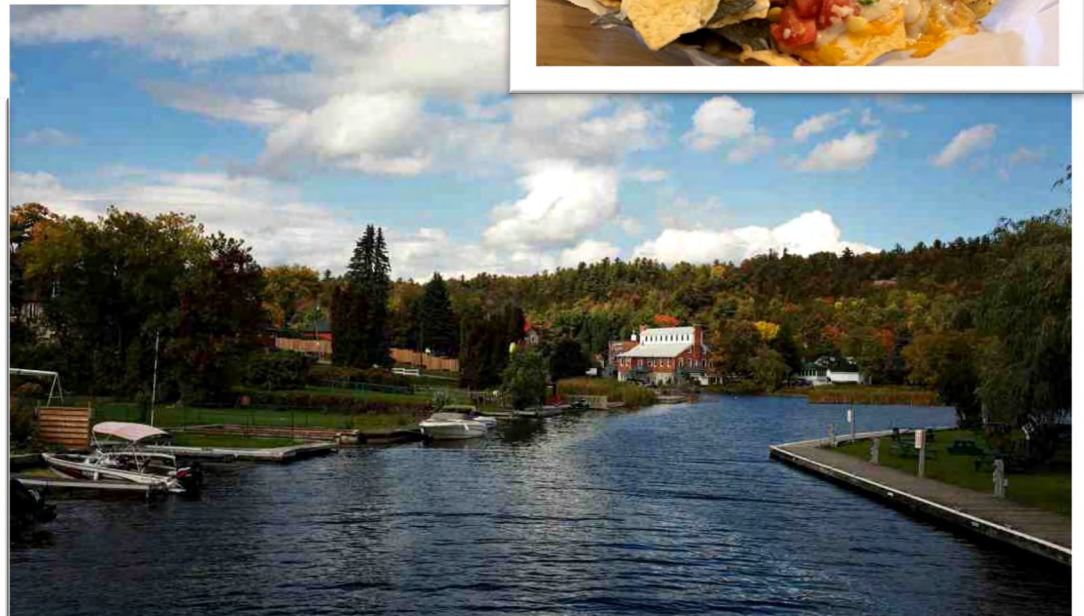
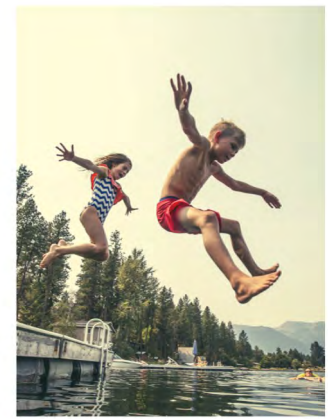
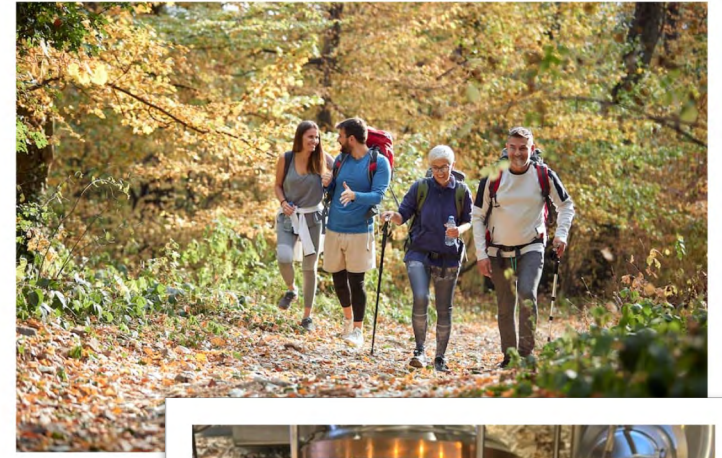
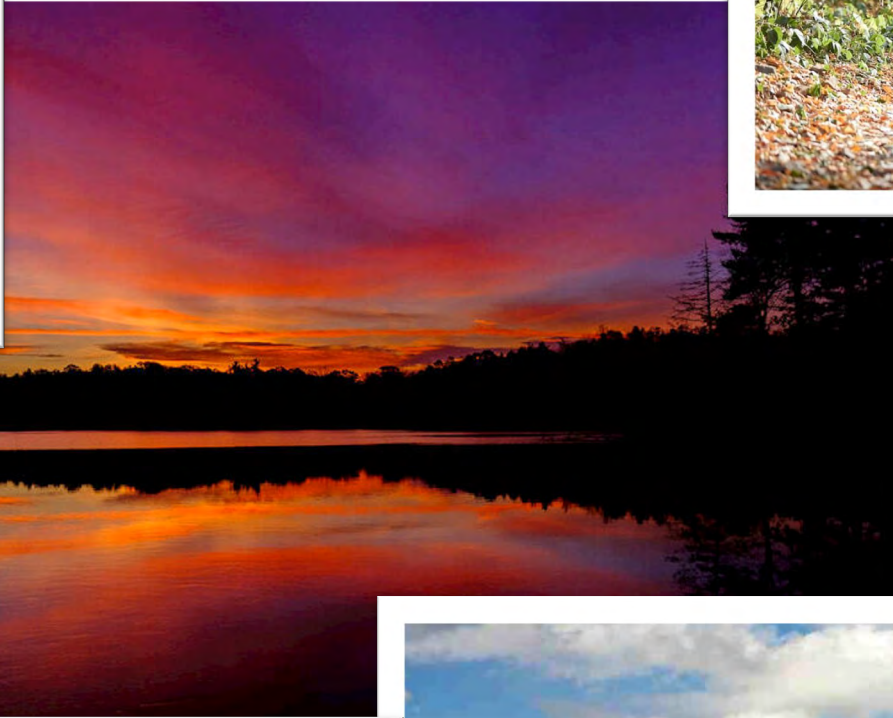
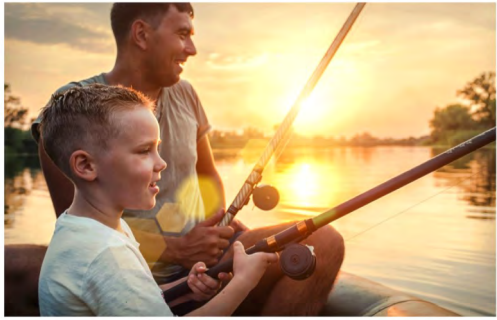

WATERCOLOUR THE COMMUNITY

Escape dense urban living to a cottage style home in Watercolour Westport. With 32 lakes within a 15 mile radius, Westport is a water lovers paradise. Watercolour is only 0.7 km walk from the beach and balances nature and neighbourhood with perfection. A four season playground surrounds the area with activities and adventures for the whole family.

Unique in its plan, Watercolour has a traditional neighbourhood design featuring wider sidewalks, front verandas and 50ft wide lots for bungalows and bungalow+loft options. A walking trail along Harvest Creek, ponds with natural wildlife and views of Foley Mountain make the neighbourhood a remarkable place.

Resource stewardship is being taken to a new level by Land Ark homes as every home being constructed is Net Zero Ready. These homes will be exceptional in their comfort, efficiency with lower utility bills and more responsible for their carbon footprint legacy. Even our interior paint absorbs CO2. Choosing exceptional standards and creating a community so you can experience new life and new possibilities is what makes Watercolour by Land Ark truly remarkable.



Lot #7

SITE PLAN

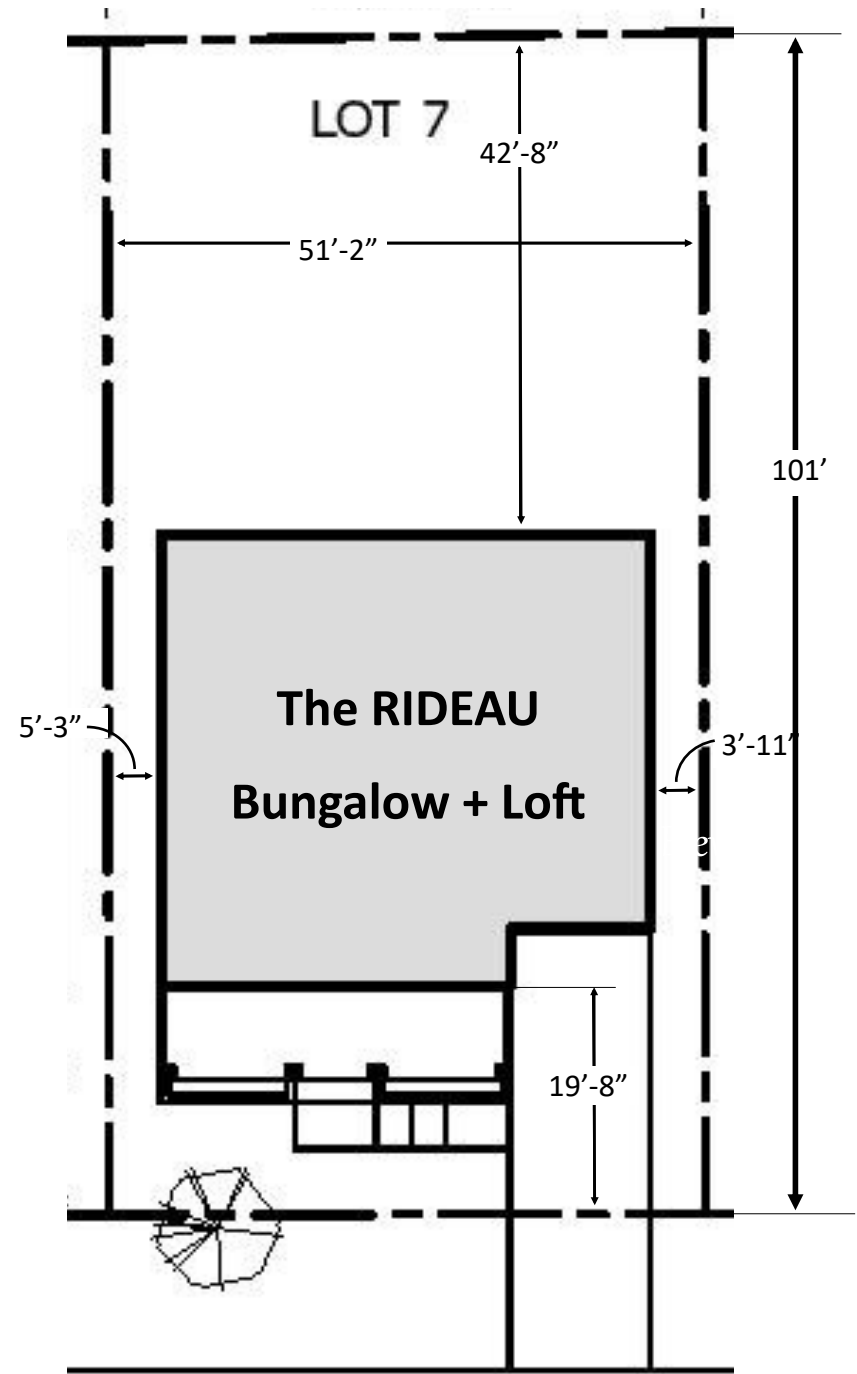
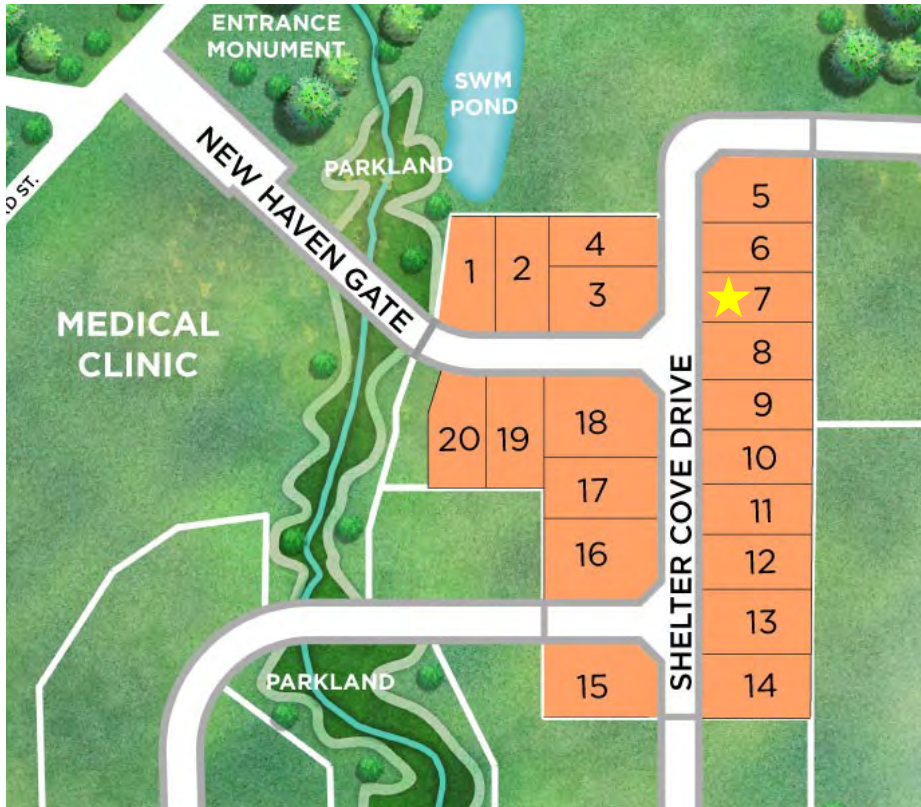

SHELTER COVE DRIVE

All images are artist's concept and may vary slightly from the final product. Actual usable floor-space may vary from stated area and square footage has been calculated based on usable living space according to the TARION rules and does not include garage or unfinished basement areas. Drawings may show optional features which may not be included in the base price. Bulkheads & box outs may be required as chases for plumbing & mechanical. Garage main door location, if applicable, may vary subject to grade. Specifications subject to change without notice. Manufacturer's images are shown and may differ from the final product. E. & O.E. May 2021.

Architecturally **BEAUTIFUL & INVITING**

EXTERIOR

1. **SHINGLES**
Owens Corning
Driftwood

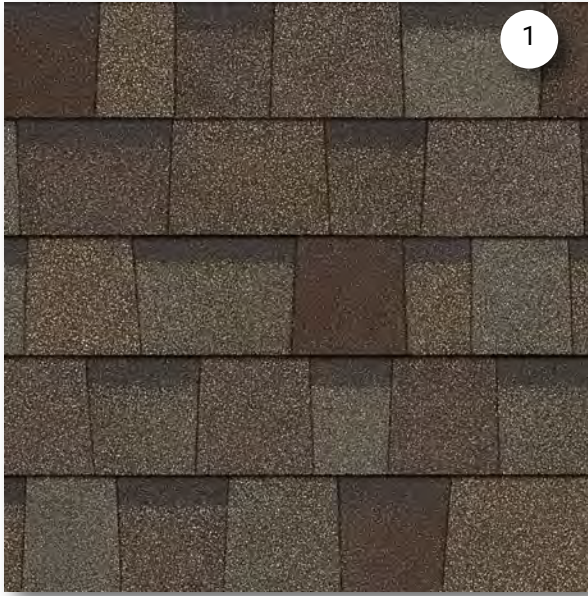

2. **SIDING**
James Hardie
Mountain Sage



3. **TRIM**
James Hardie
Cobblestone



4. **SOFFIT/FACIA**
Cashmere

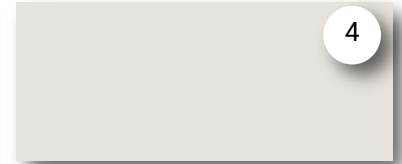

5. **WINDOWS**
Jeld-Wen
Sandalwood

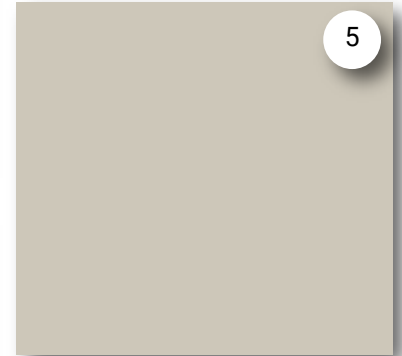

6. **GARAGE DOOR**
Garaga
Chocolate Walnut

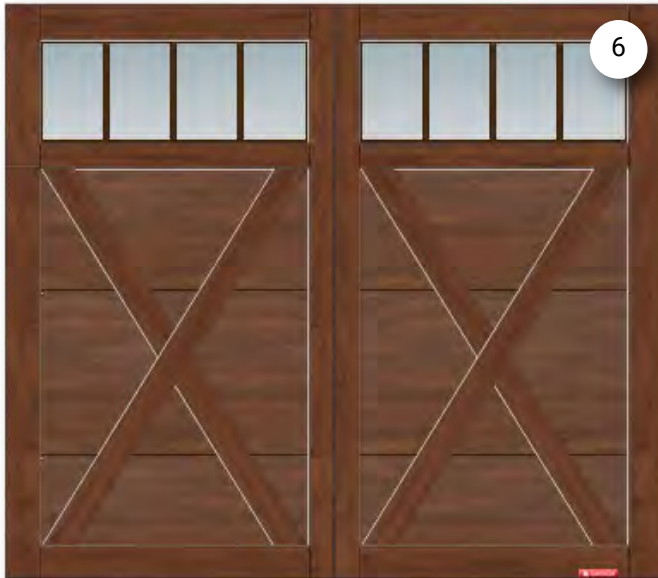

7. **FRONT DOOR**
Concord Ivory

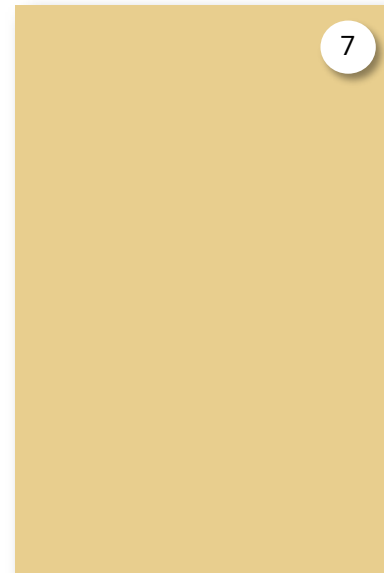

8. **DOOR HARDWARE**
Weiser - Vancouver
Matte Black



9. **POSTS**
Ballet White

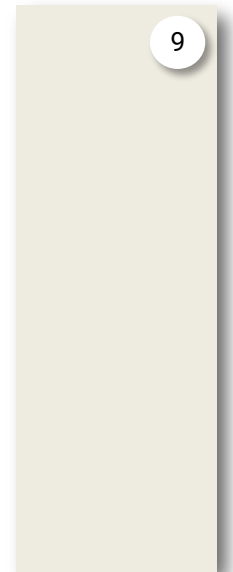

Make a grand entrance with **DESIGNER CURATED ELEMENTS**

INTERIOR

1. DOORS

Masonite - Winslow
White



2. FOYER FLOOR TILE

Midgley West - Marmette
24" X 24" white



3. WALL COLOUR

Graphenstone - Ecosphere
Silver

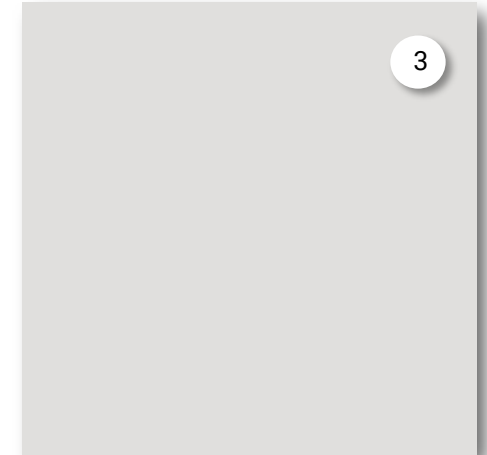

4. DOOR HANDLES

Weiser - Halifax
Matte Black



5. HARDWOOD FLOOR

Gaylord Hardwood Flooring
White Oak - Beach Sand



8. CEILING COLOUR

Graphenstone
White

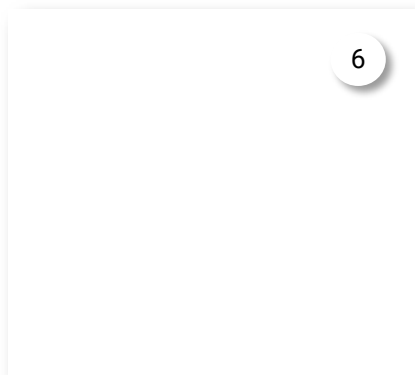

7. TRIM

White 5" baseboards
White 3" window trim

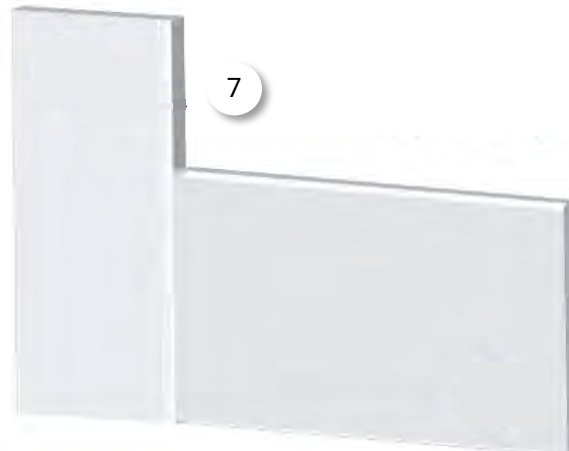

A place to gather in **WARMTH & BEAUTY**

FIREPLACE

1. FIREPLACE

Dimplex Ignite Electric 50"
with Driftwood and Rock
accessory package

2. MANTLE

Recovered barnwood
from Rice Farm



All images on all pages are artist's concept and may vary slightly from the final product. Actual usable floorspace may vary from stated area and square footage has been calculated based on usable living space according to the TARION rules and does not include garage or unfinished basement areas. Images may show optional features which may not be included in the base price. Bulkheads & box outs may be required as chases for plumbing & mechanical. Garage main door location, if applicable, may vary subject to grade. Specifications subject to change without notice. Manufacturer's images are shown and may differ from the final product. E. & O.E. May 2021.

A great recipe starts with a **WELL APPOINTED KITCHEN**

KITCHEN

1. RANGE HOOD

General Electric
Stainless Steel



CABINETS

Lausyen - Maui
2. Revere Pewter
3. Carolina Gull

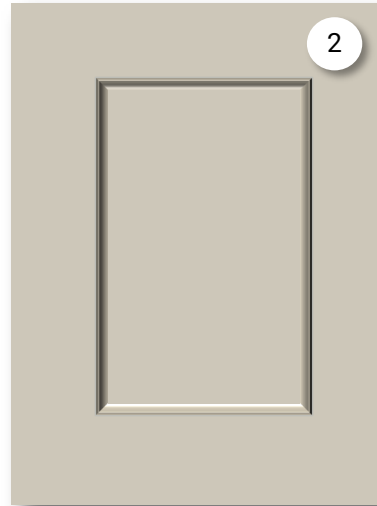

4. FAUCET

Moen
Brushed gold



5. BACKSPLASH

Olympia
Shade Brick
3"x12" -light



6. COUNTERTOP

Quartz -Tofino

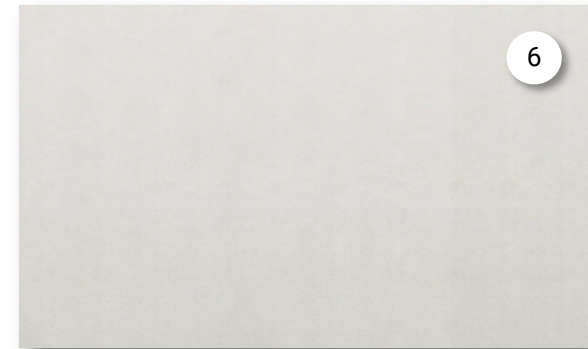

7. DOUBLE SINK

Urban Quarry
Stainless Steel



8. CABINET PULLS

Rocheleau - brushed gold



9. HARDWOOD FLOOR

Gaylord Hardwood Flooring
White Oak - Beach Sand



A retreat to pamper yourself in **SPA-LIKE ELEGANCE**

ENSUITE BATHROOM

1. SINK FAUCET

Delta - Black

2. CABINETS

Lauryzen - Maui

Revere Pewter

3. SHOWER FLOOR TILE

Midgley West—Travertini

2" X 2" - grigio natural

4. WALL COLOUR

Graphenstone, Grafclean

Silver

5. BATHROOM FLOOR TILE

Midgley West -Travertini

24" X 24" Grigio Natural

6. SINK

Urban Quarry - undermount

White

7. CABINET PULLS

Rocheleau - Black

8. COUNTERTOP

Quartz -Tofino

9. TOILET

American Standard

White

10. SHOWER WALL TILE

Midgley West -Travertini

18" X 36" -grigio natural

11. SHOWER DOORS

Kalia - black finish

12. SHOWER FIXTURE

Kalia - black



1. **SINK FAUCET**

Moen - brushed gold

2. **WALL COLOUR**

Graphenstone Paint
Silver

3. **CABINET PULLS**

Rocheleau - brushed gold

4. **WALL TILE**

Midgley West - High Society
12"X24" Super White

5. **CABINETS**

Lauryzen - Maui
Carolina Gull

6. **SINK**

Urban Quarry - undermount
White

7. **FLOORING**

Midgley West - Ghost Play
8"X 8" Classic Sage

8. **COUNTERTOP**

Quartz - Tofino

9. **TOILET**

American Standard
white

10. **SHOWER/TUB FAUCETS**

Moen
Brushed gold

11. **TUB**

Neptune - Juna
white

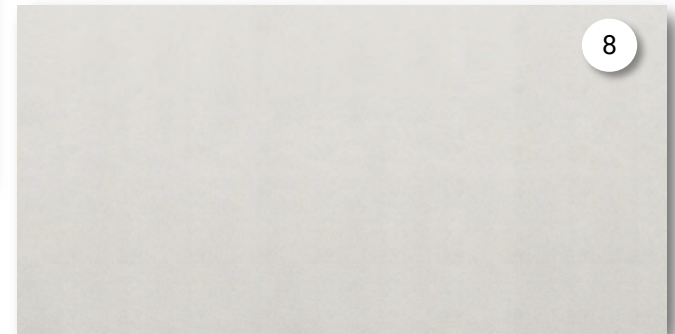
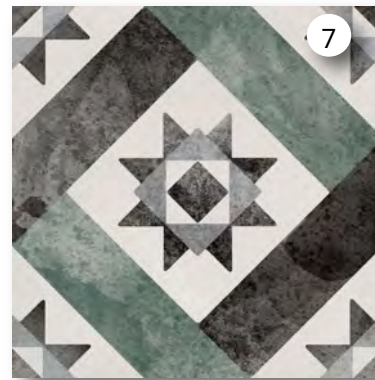
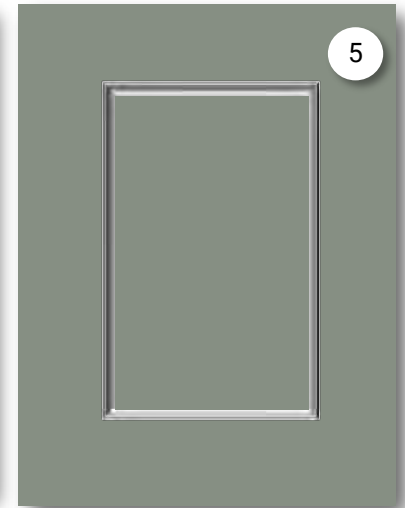
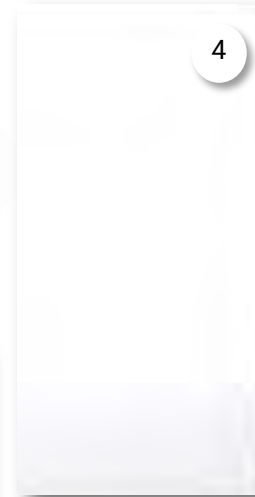
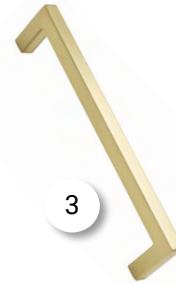
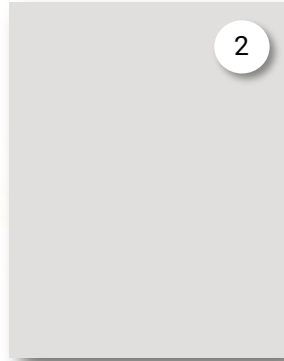

A beautiful blend of **MODERN & LUXURY**

MAIN BATHROOM

A place where **FUNCTION MEETS ELEGANCE**

LOFT BATHROOM

1. CABINETS

Laurysen - Maui
Revere Pewter

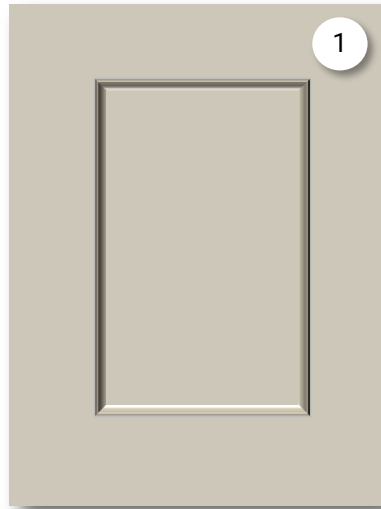

2. WALL TILE - side walls

Midgley West - High Society
12"X24" super white

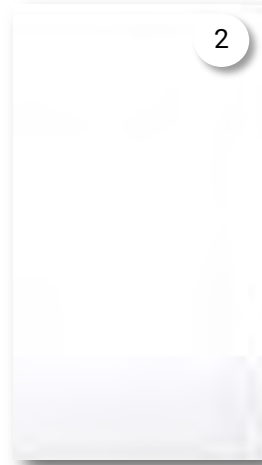

3. SINK

American Standard
White



4. WALL COLOUR

Graphenstone
Silver

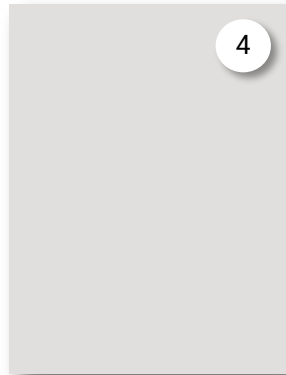

5. CABINET PULLS

Richelieu - black



6. WALL TILE - back wall

Sarana Winsor Cold MT
8'X20" applied vertically



7. FAUCET

Delta - black



6. COUNTERTOP

Wilsonart
White Cascade



9. SHOWER/TUB FAUCETS

Delta - black



10. TUB

Neptune Juna



11. TOILET

American Standard
white





WATERCOLOUR
WESTPORT

New Homes New Life New Possibilities

WatercolourWestport.com

Email: info@watercolourwestport.com

All images on all pages are artist's concept and may vary slightly from the final product. Actual usable floorspace may vary from stated area and square footage has been calculated based on usable living space according to the TARION rules and does not include garage or unfinished basement areas. Images may show optional features which may not be included in the base price. Bulkheads & box outs may be required as chases for plumbing & mechanical. Garage main door location, if applicable, may vary subject to grade. Specifications subject to change without notice. Manufacturer's images are shown and may differ from the final product. E. & O.E. May 2021.